

TWAIN CENTER

4401 Twain Ave., #9

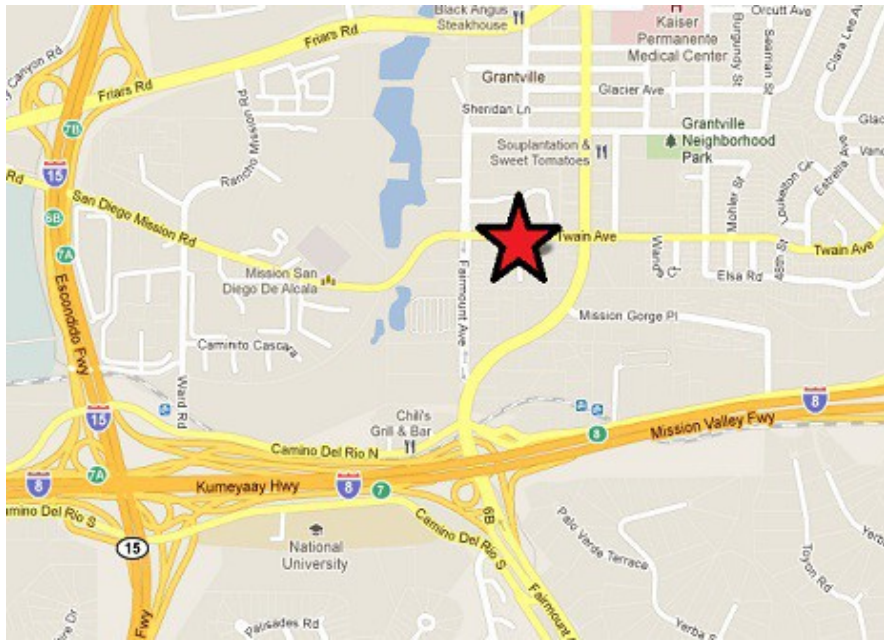

Approx. 500 sf.
Warehouse w/ Office



Rate: \$1.85ft. Or \$925 /month
Industrial gross

Term: 1 - year

Available: Now

Description: one large
warehouse area, grade level
7'9" x 8 ft. high truck door,
no heat or a/c in space.
Common restroom in
complex, no running water
or restroom in space.

For more information call:

858.272.7070

Joan Barnes

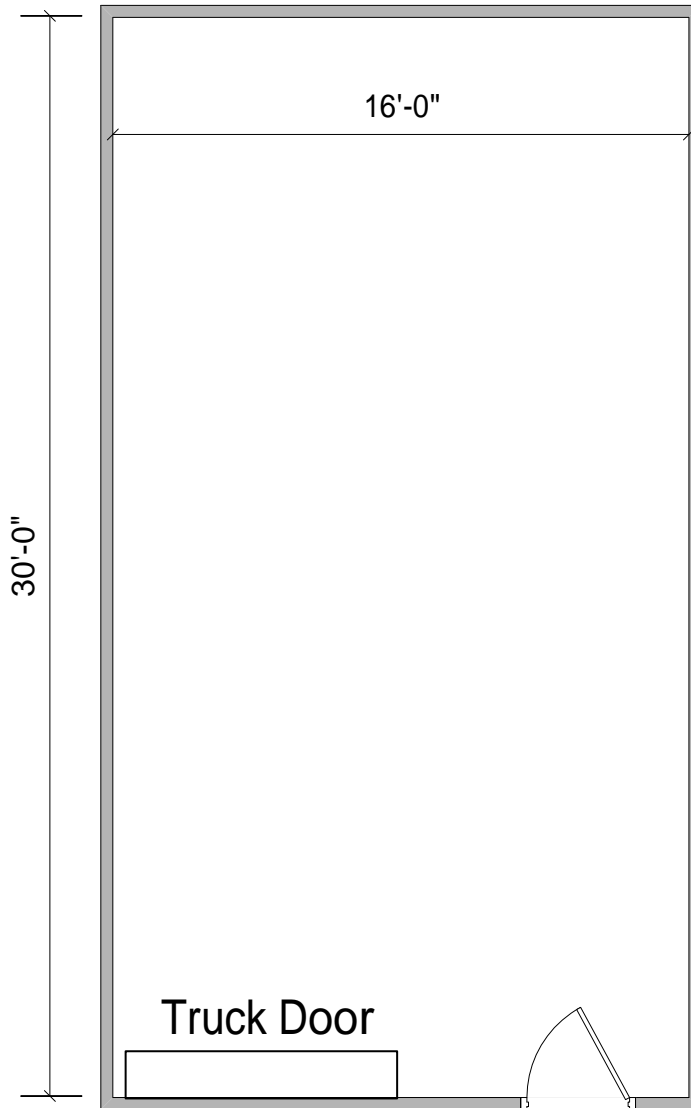

Joan Barnes – (858) 272-7070



4401 Twain Ave. # 9
500 SF