

TWAIN CENTER

4401 Twain Ave., #3



Approx. 720 sf.
Warehouse w/ Office



Rate: \$1350 /month

Term: 1-3 years

Available: Now

Description: Reception and office,

Warehouse and truck door.

A/C in office. Common

Restrooms in complex, no water in suite.

For more information call:

858.272.7070

Joan Barnes

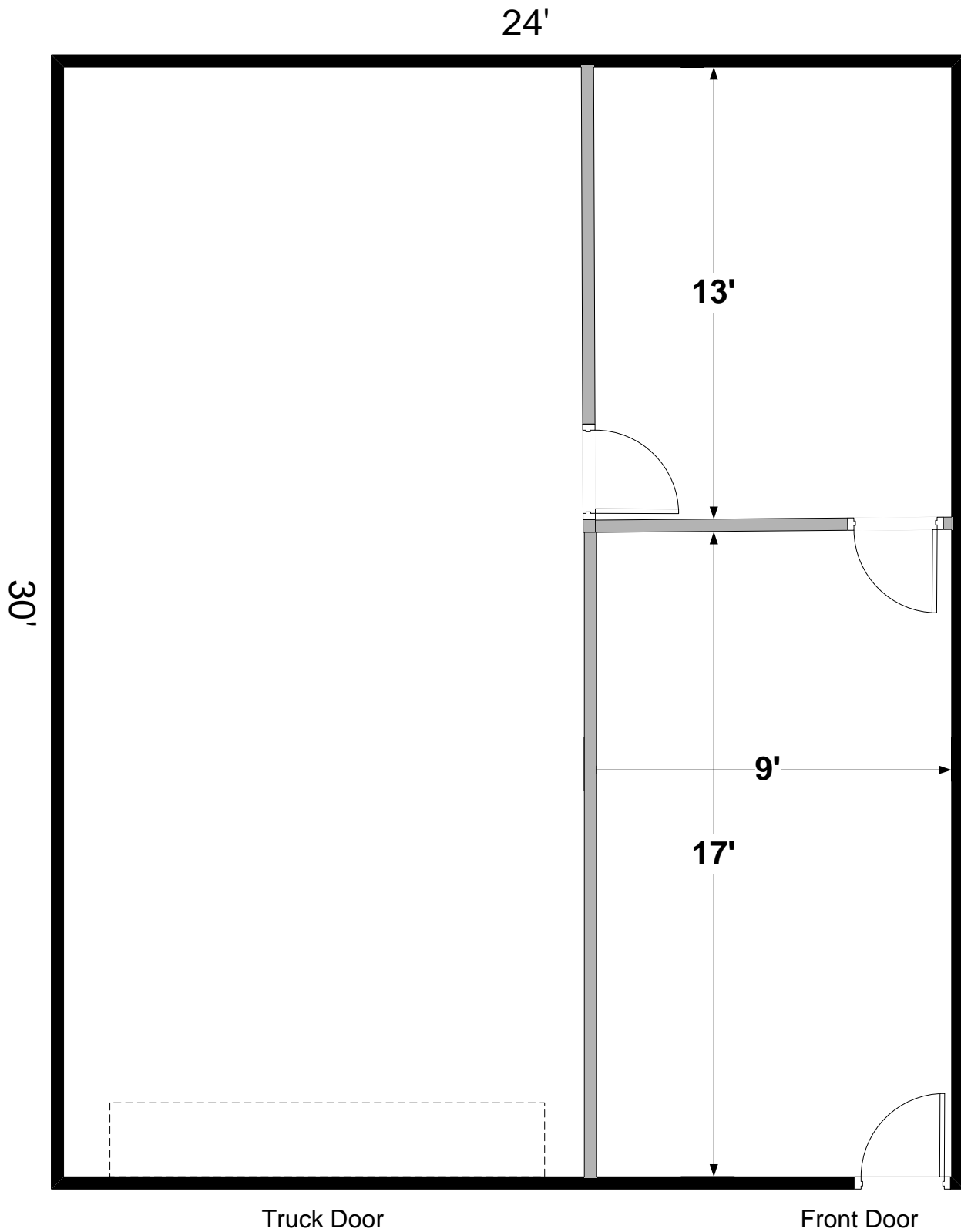

Truck Door

Front Door



4401 Twain Ave. #3 - 720 SF

Joan Barnes – (858) 272-7070