

# TWAIN CENTER

4401 Twain Ave., #23



Approx. ~720 sf.  
Warehouse w/ Office



Rate: \$1.87/foot or  
\$1350/month industrial gross

Term: 1 year

Available: Now

Description: Large office,  
small office, warehouse  
area, grade level 10 x 10 ft.  
truck door, a/c in offices.  
Common restroom in  
complex, no running water  
or restroom in space.

For more information call:

**858.272.7070**

Joan Barnes

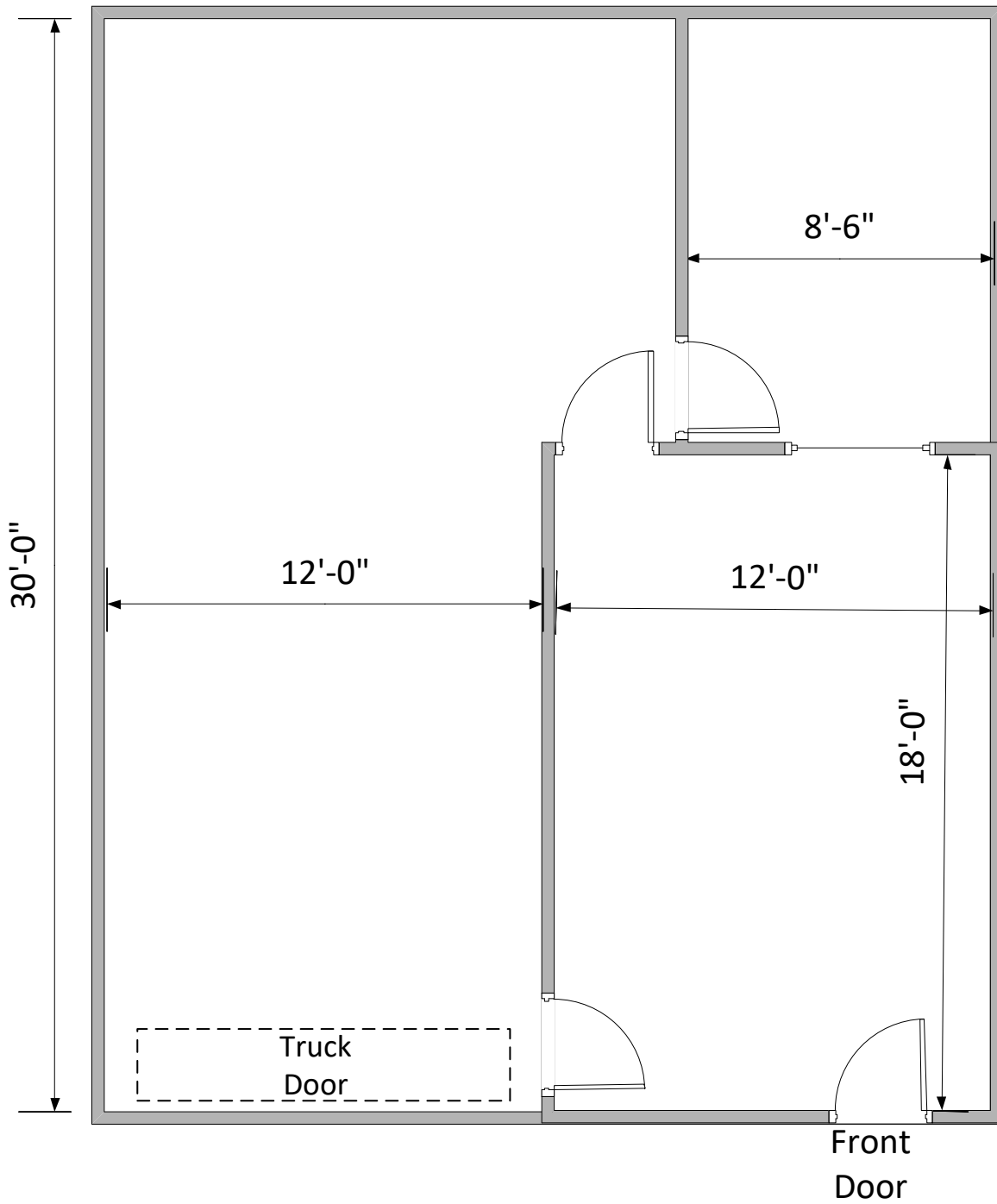

Joan Barnes  
(858) 272-7070

4401 Twain Ave. #23