

TWAIN CENTER

4401 Twain Ave., #15 & #16



Approx. 1392 sf.
Warehouse w/ Office



Rate: \$2700/month

Term: 1-3 years

Available: October 1, 2025

**Description: Office and
storage room,
warehouse and truck door.**

**A/C in office. Common
restrooms in complex, no
water in suite.**

For more information call:

858.272.7070

Joan Barnes

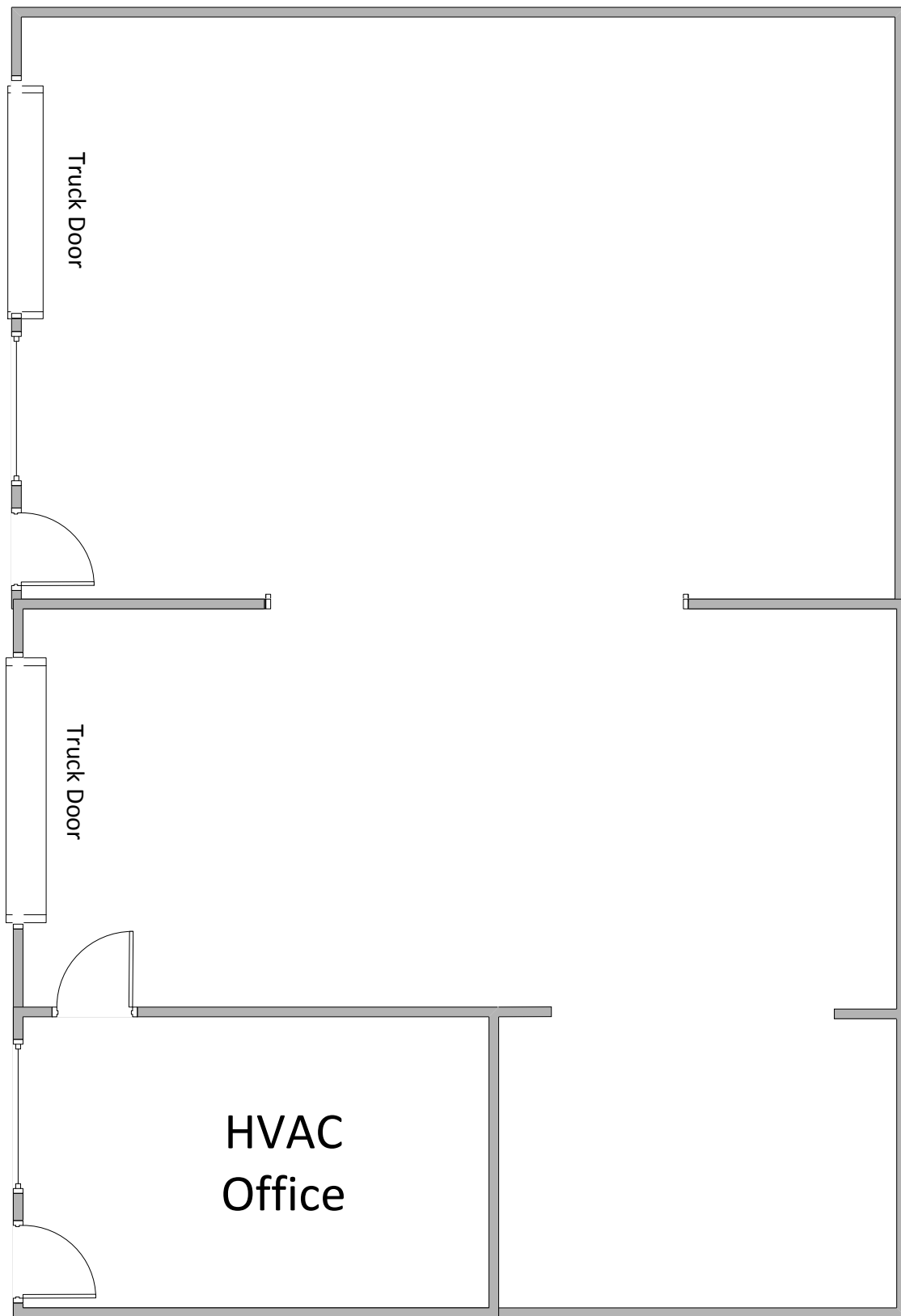

4401 Twain Ave. – 1392 SF

Joan Barnes – (858) 272-7070